

29-10-61

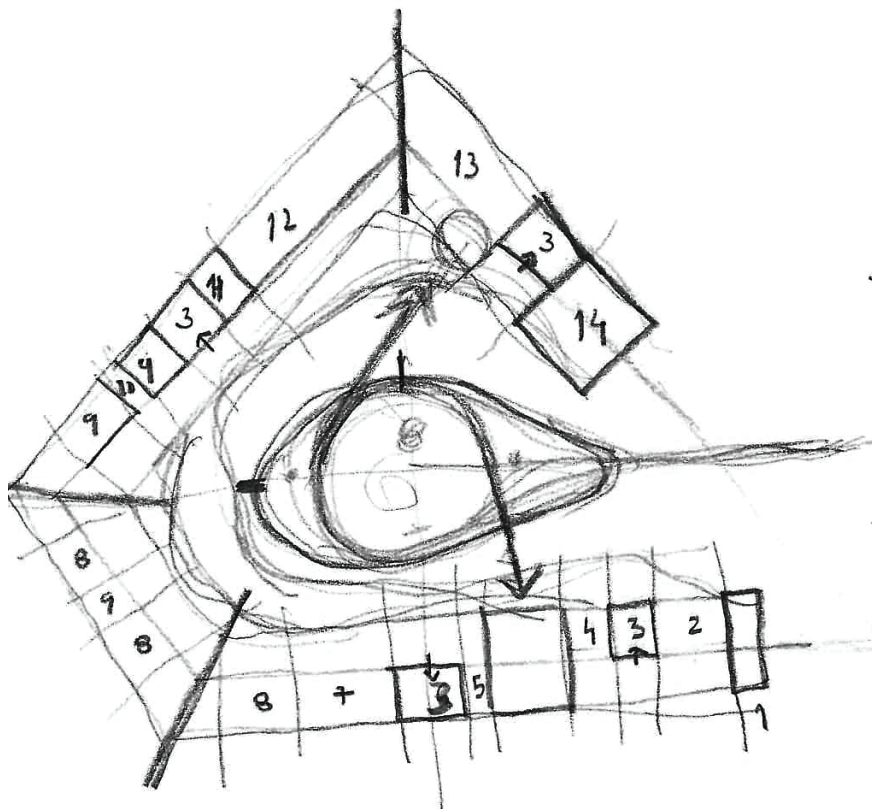

- 1 Administração 8
- 2 Secretaria
- 3 WC'S
- 4 Sala de Reuniões
- 5 Recepção + Armazenagem
- ~~6~~
- 7 Sala de Espera
- 8 Sala de Trabalho
- 9 Laboratório (Centro de Invest.)
- 10 Armazenagem (Centro de Invest.)
- 11 Loja de Vendas
- 12 Queijaria
- 13 Bar/Contina
- 14 Auditorio

29-10-61

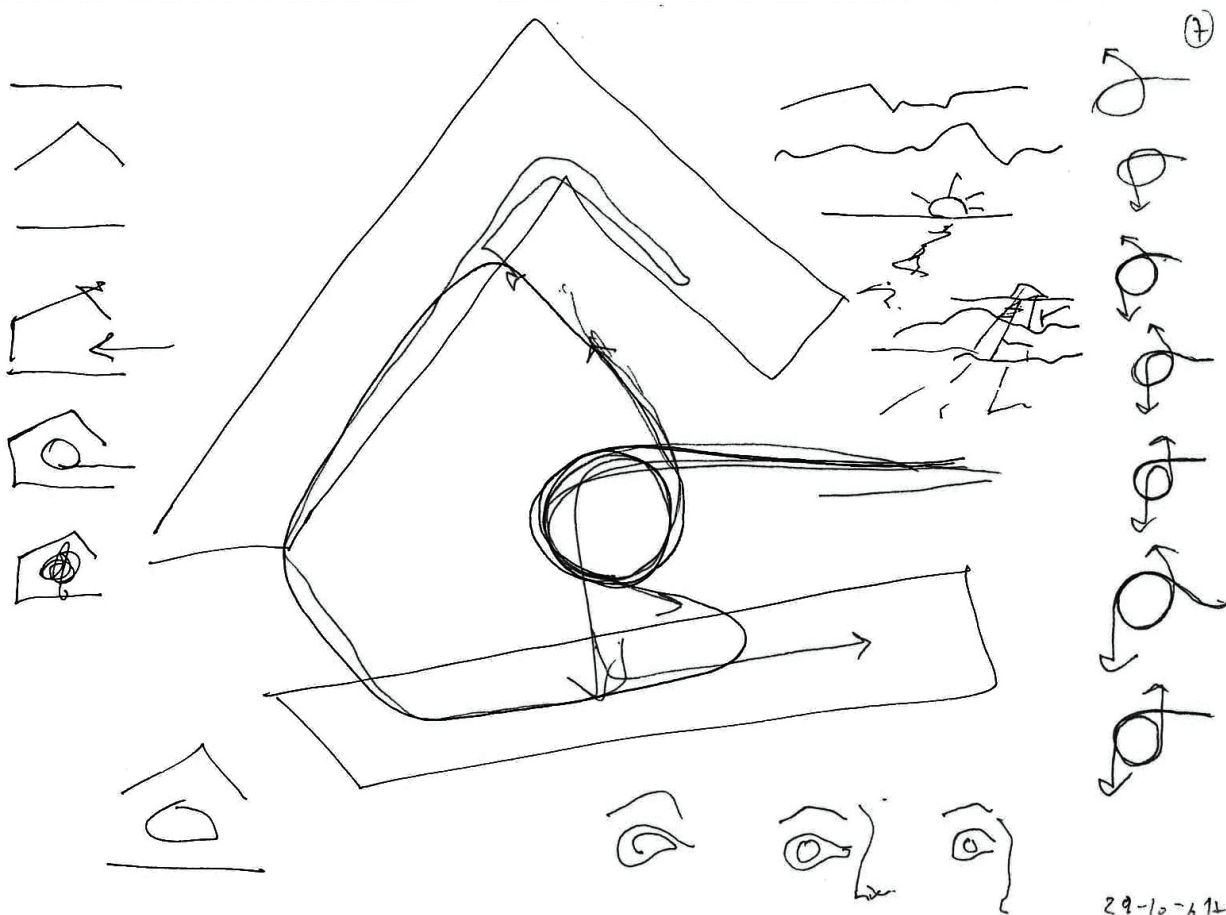

29-10-41

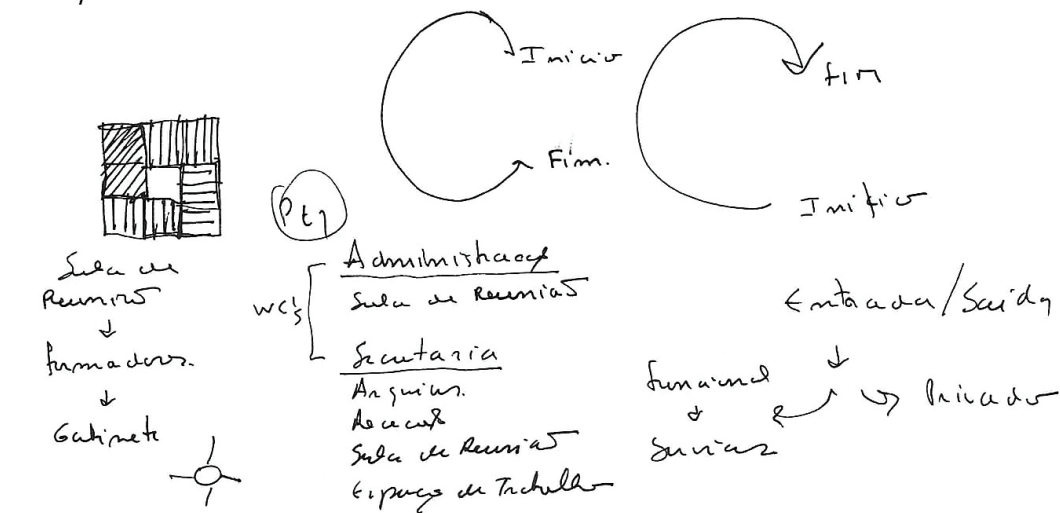
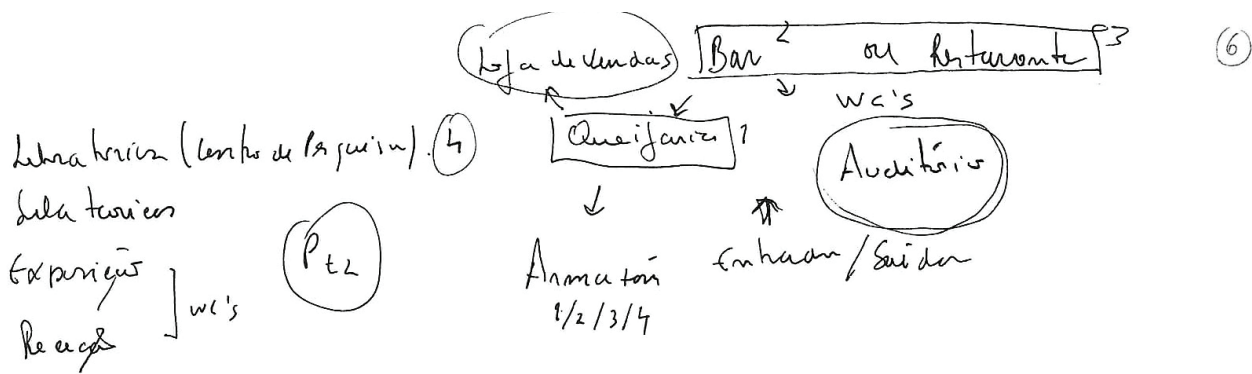

29-10-41

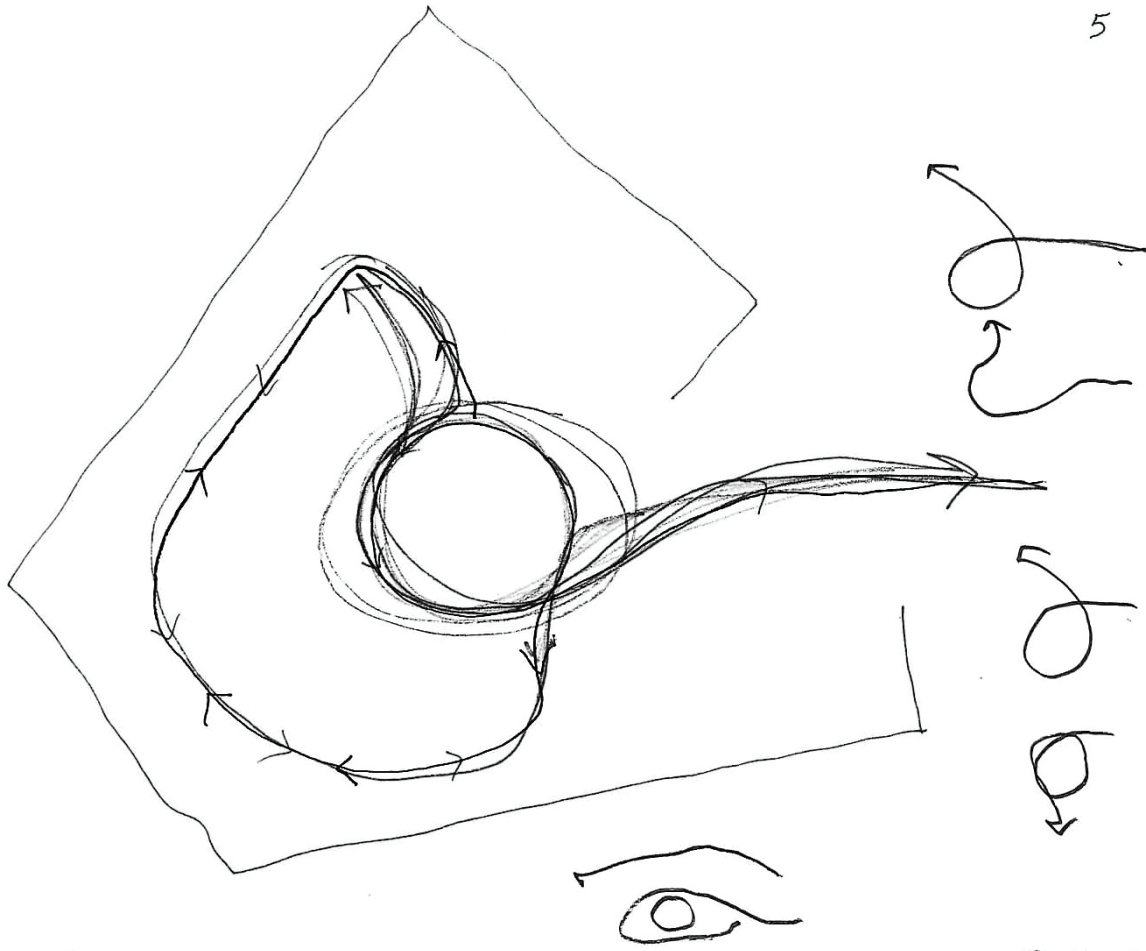

29-10-21+

Bar / Restaurante
wc's

wc's Auditório

Área 3688 m²

Sala de Exposição
 - Teórica
 - Níveis Investigação

Loja de Vendas

(4)

wc's [Salas Teóricas
 Laboratórios

Administração
 Secretaria
 Sala de reuniões
 (wc's)
 Gabinete

Recepção.

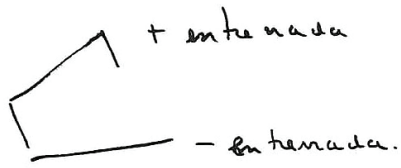
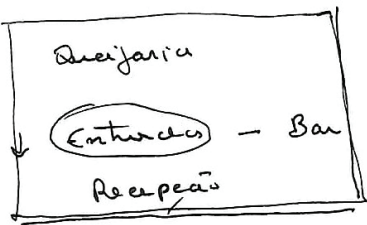

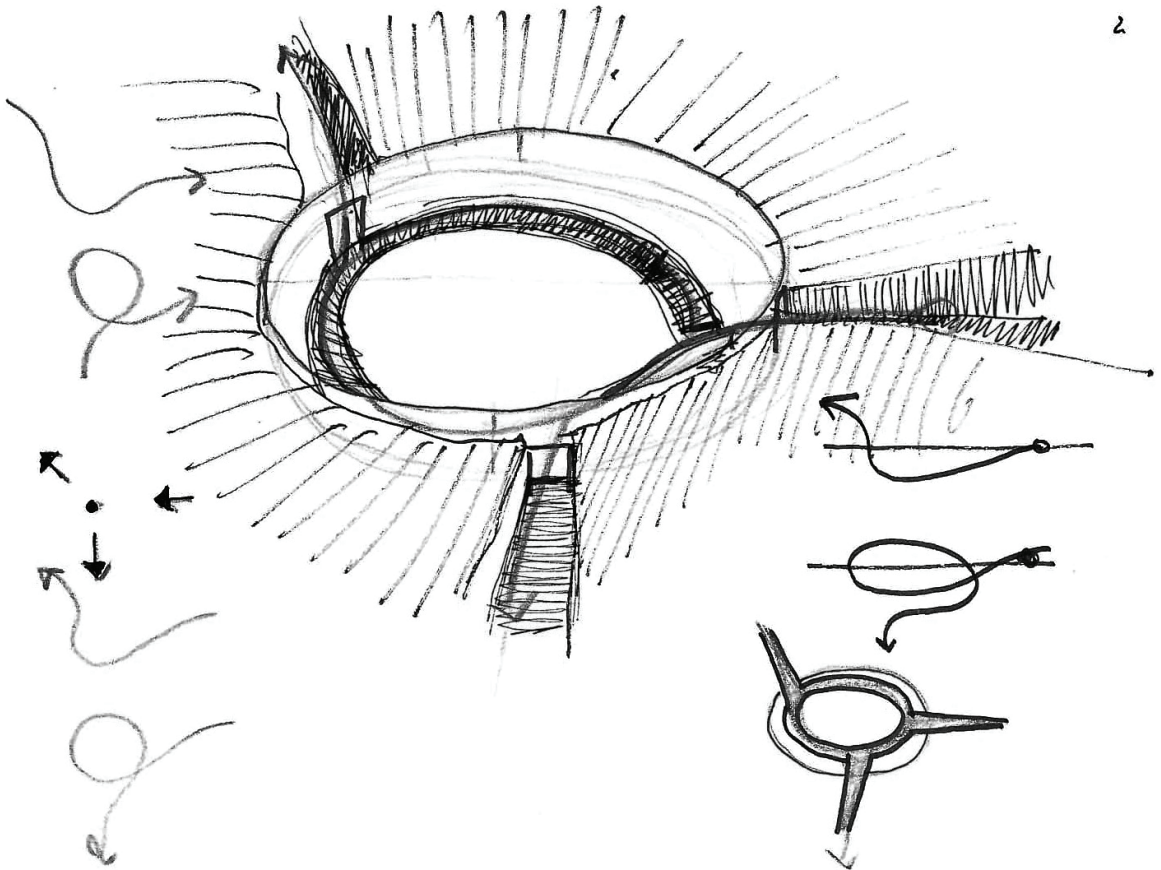
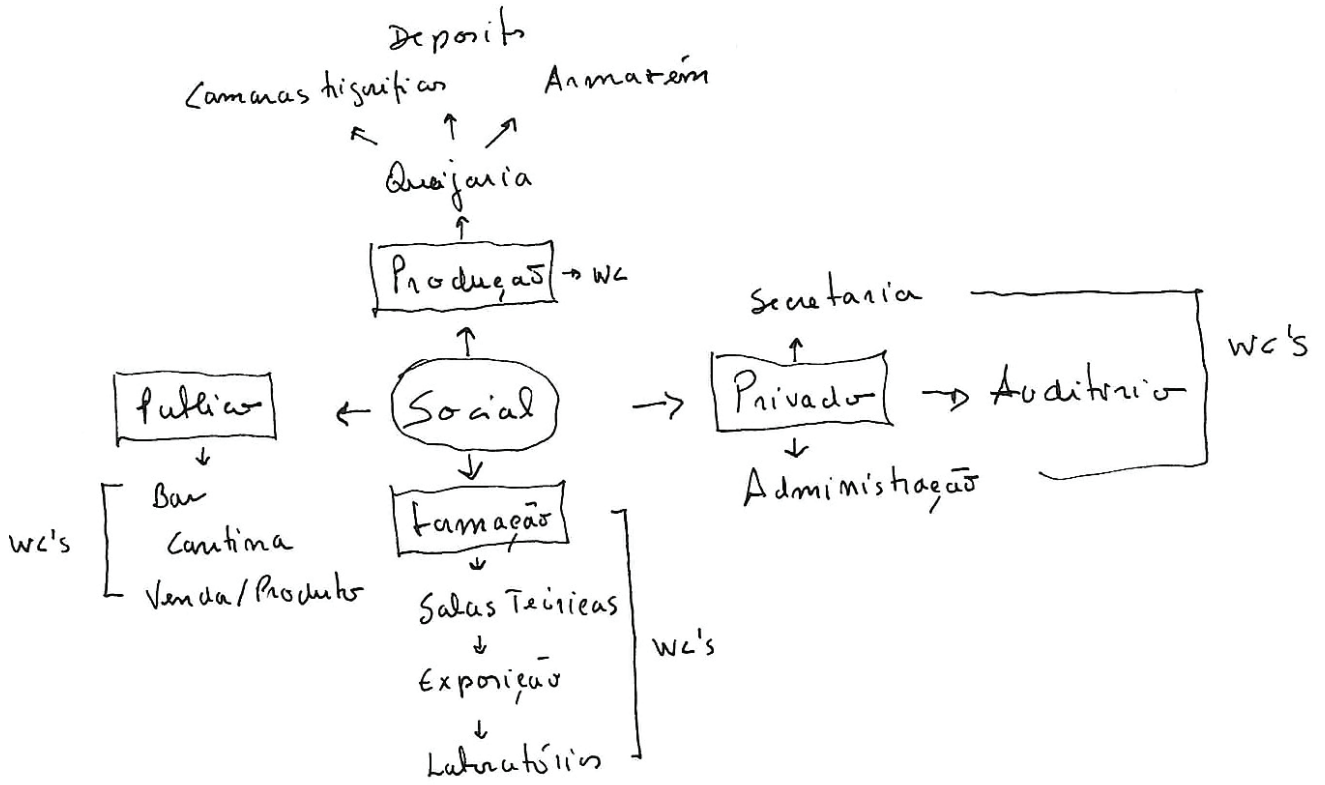

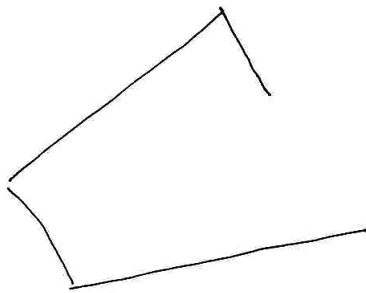

=

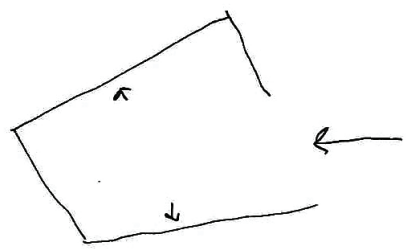
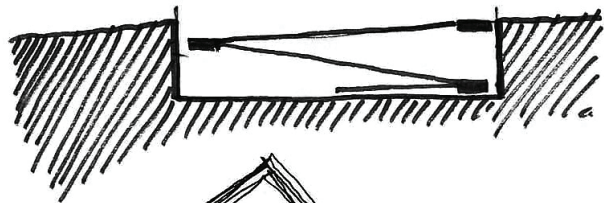
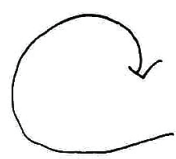

=

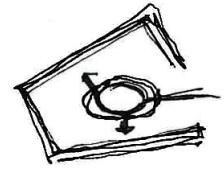
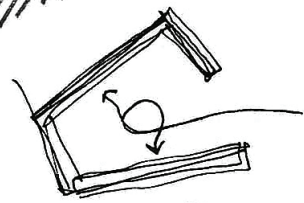

29-10-21

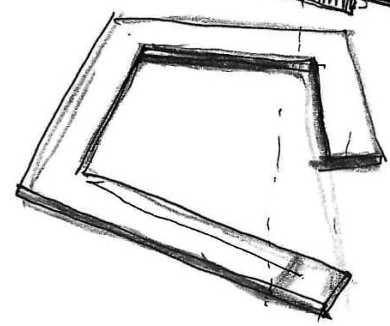
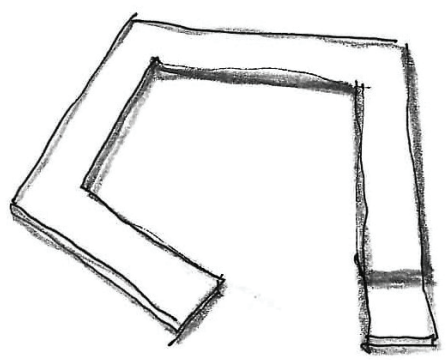
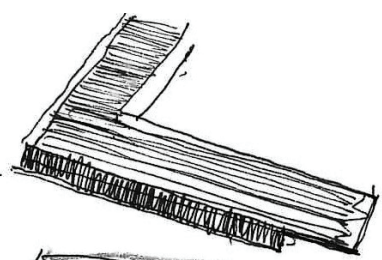

16-10-21

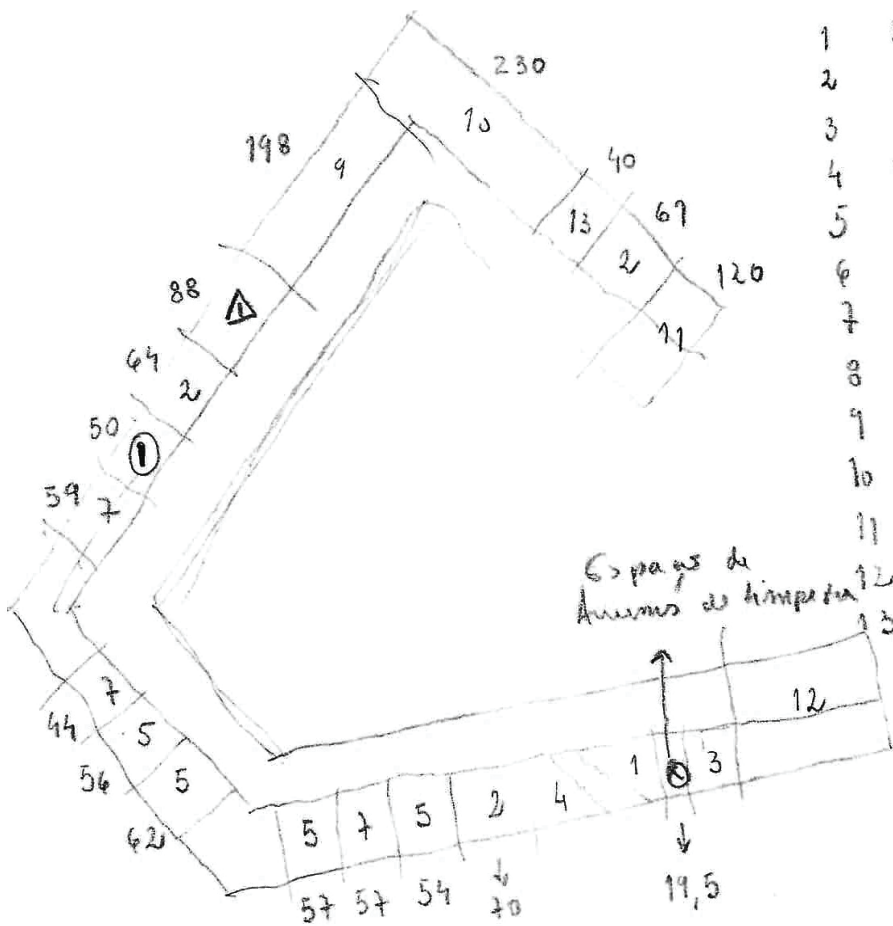
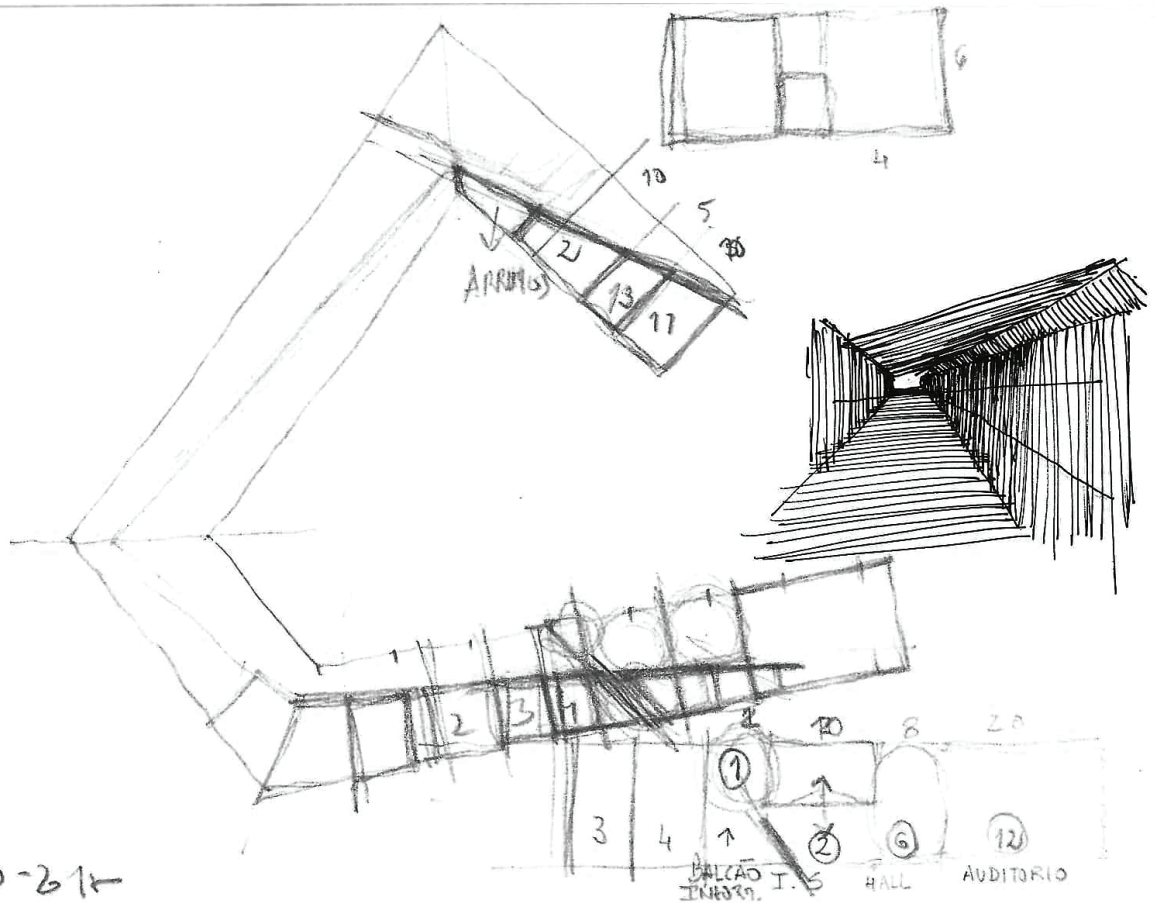

1	40
2	
3	44
4	45
5	229
6	
7	160
8	
9	198
10	230
11	120
12	252
13	

△ 88
(História do Queij)

⊗ 19,5
(Empregados)

⊙ 50
(exibições de produtos)

22-10-21

3

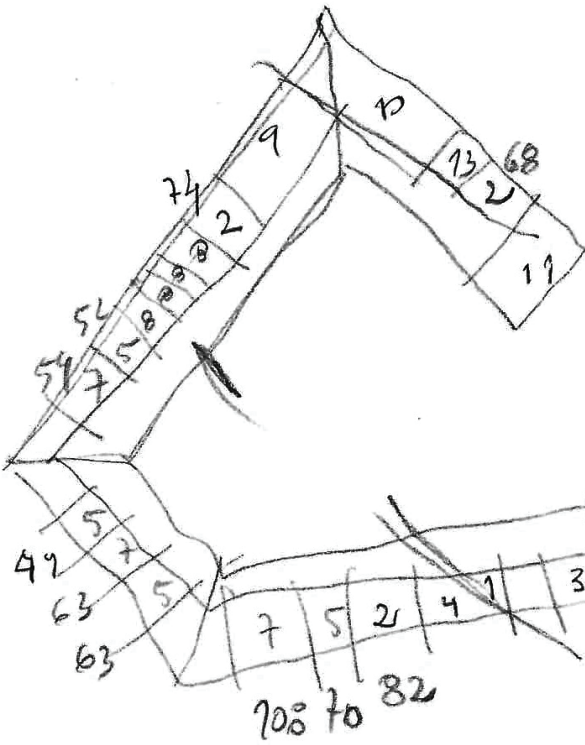

1	20		
2	10 224	3	
3	57		
4	50		
5	230	4	
6			
7	230	3	
8	114	4	
9	190		
10	260		
11	156		
12	255		
13	46		

21-10-21t

+ - 6 IS

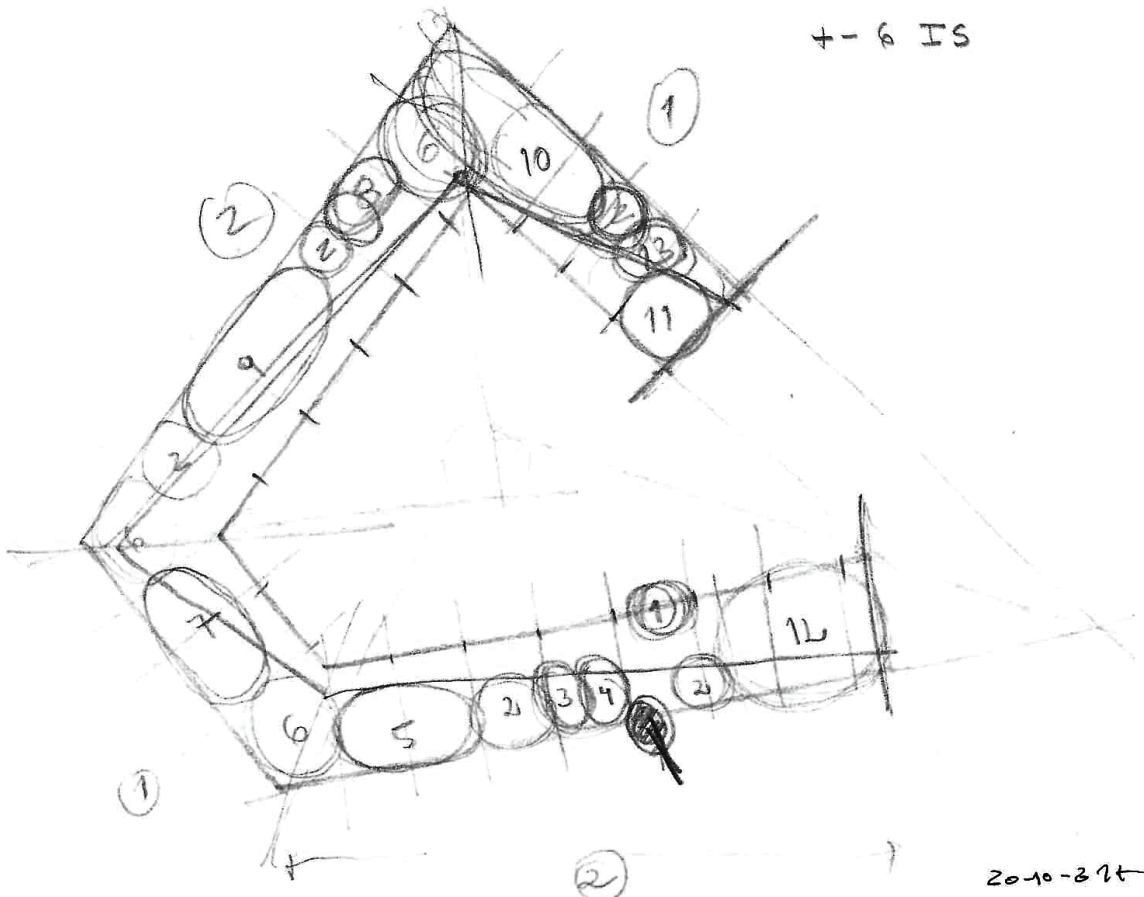

20-10-21t

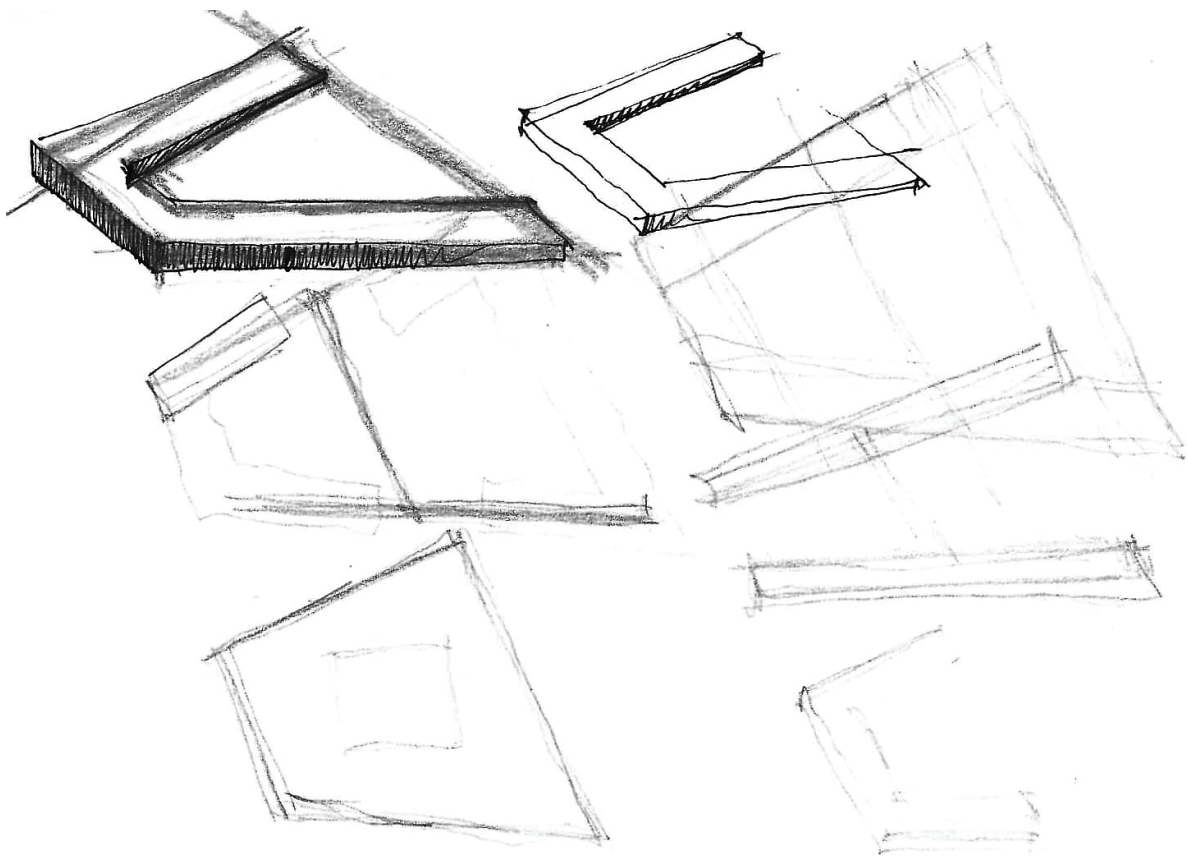

16-10-61

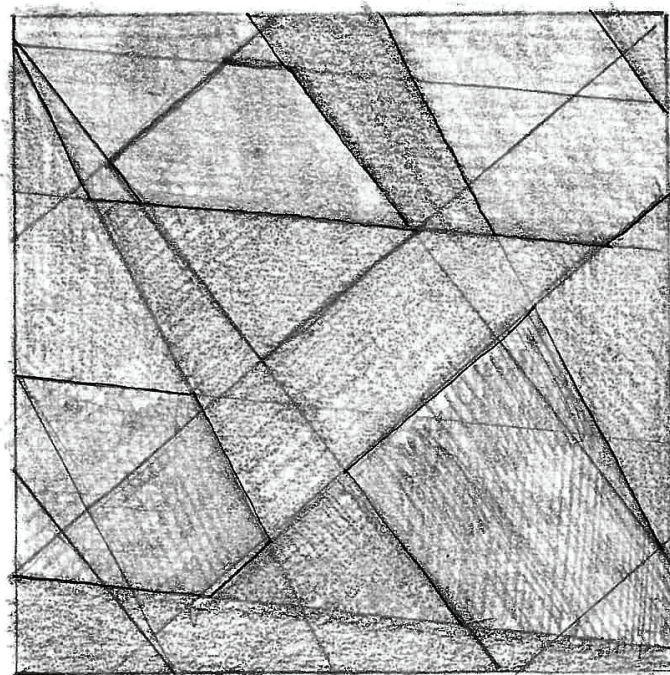

16-7-21

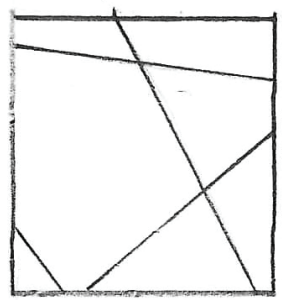
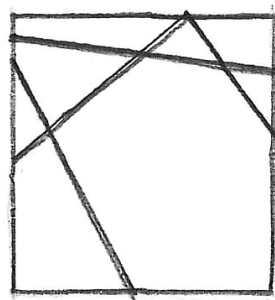
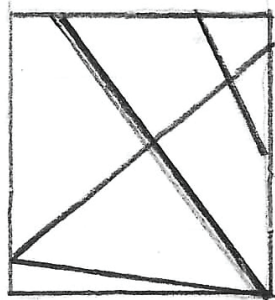
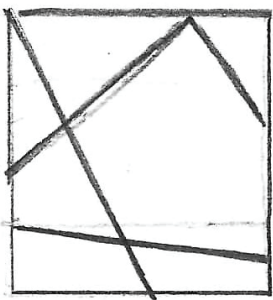
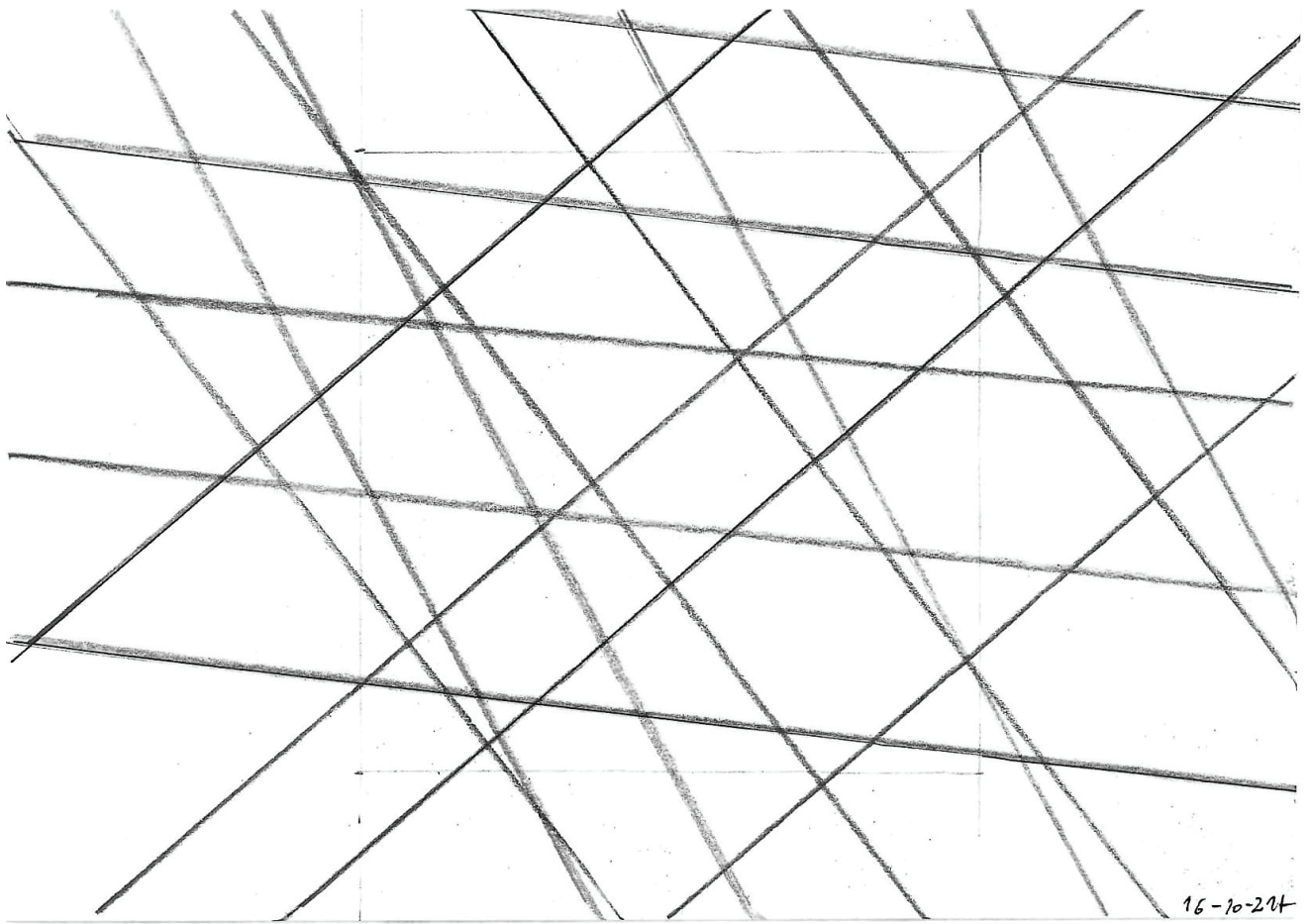

16-10-21+

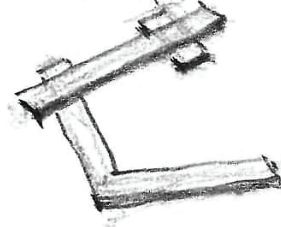
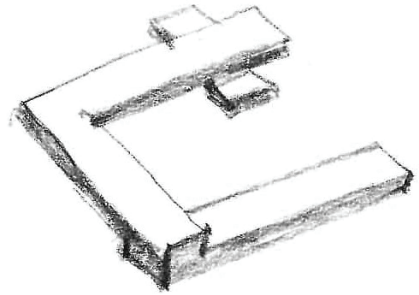
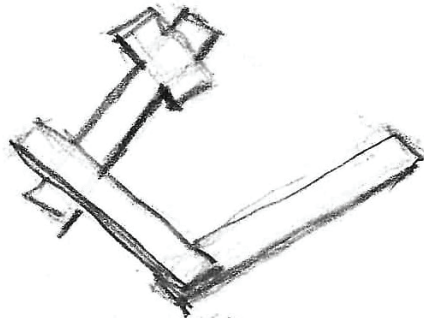
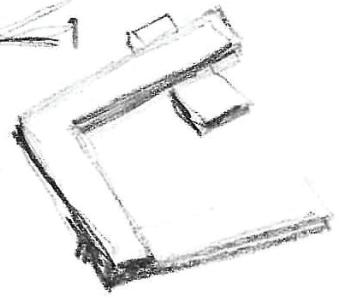
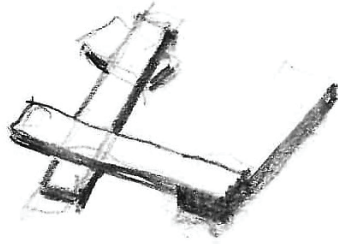

14-10-21+

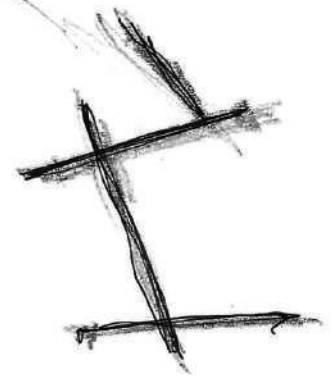
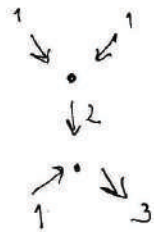

14-10-21+

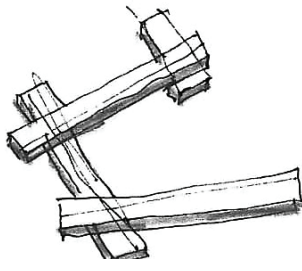
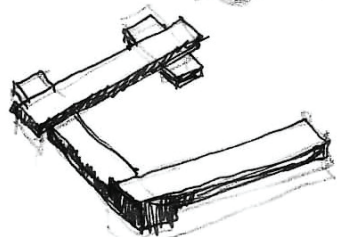
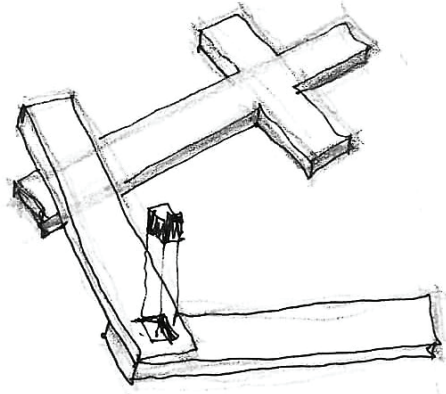
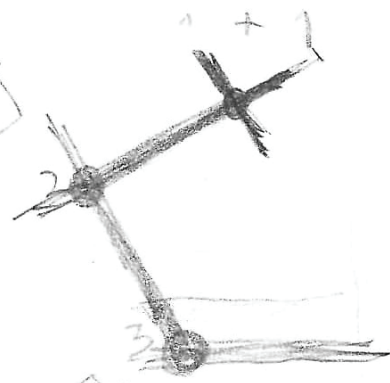
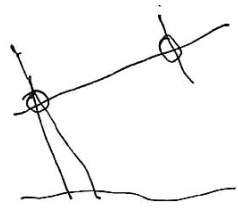

14-10-294

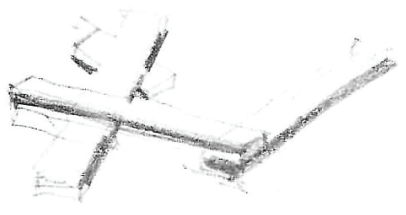
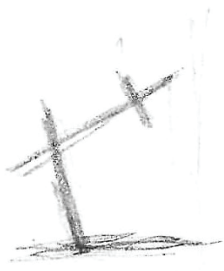
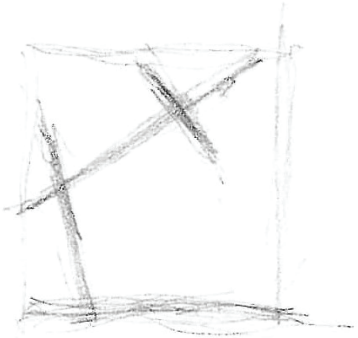
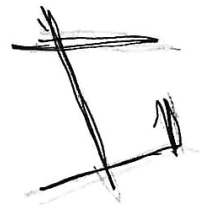
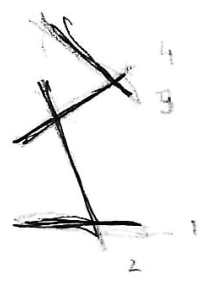

14-10-294

10-10-67

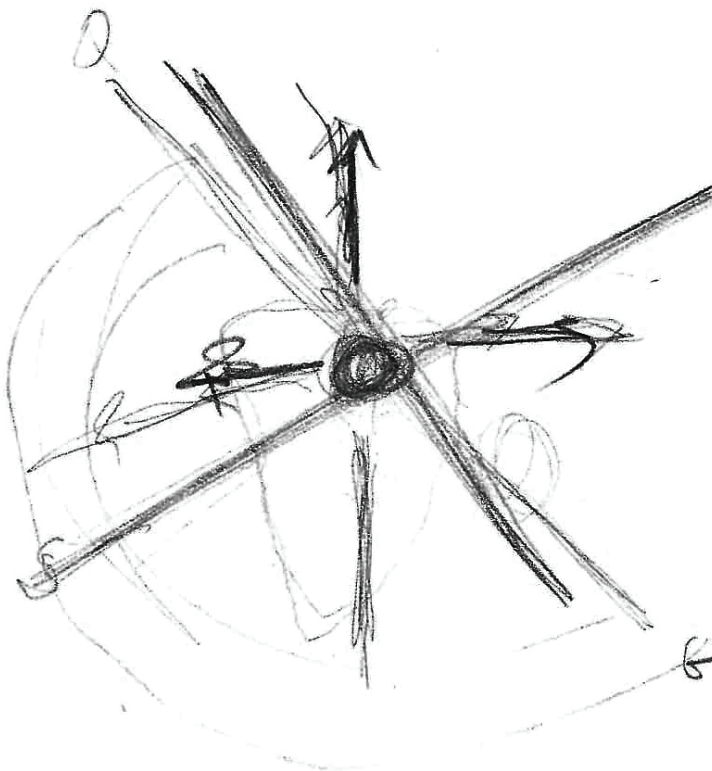
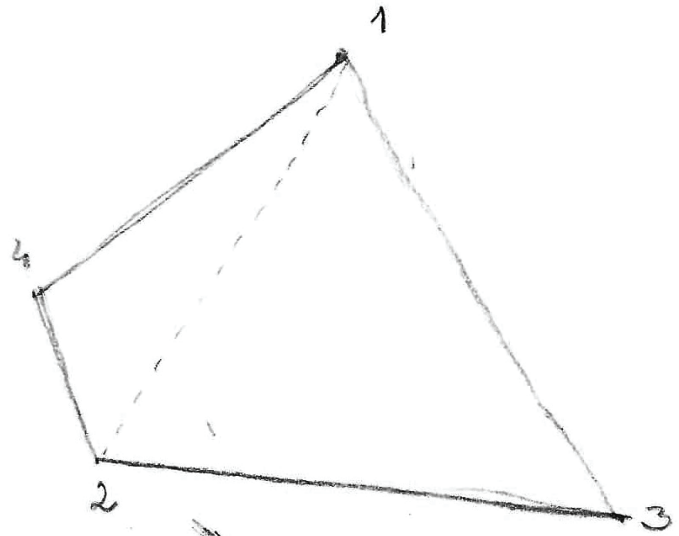
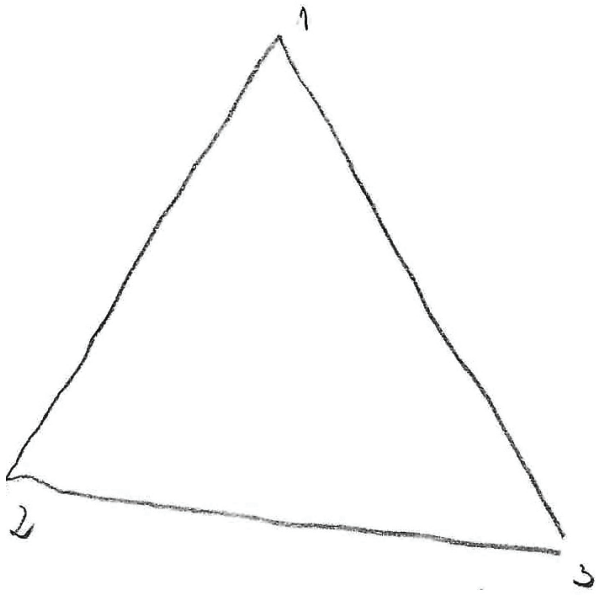

Acridomus

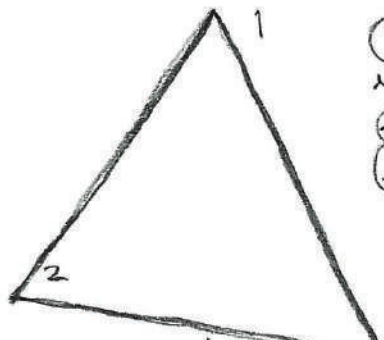

- ① Grupos de Hotelaria e Turismo
- ② Centro de Interpretação
- ③ Museu do Pão

Do terreno à Torre.

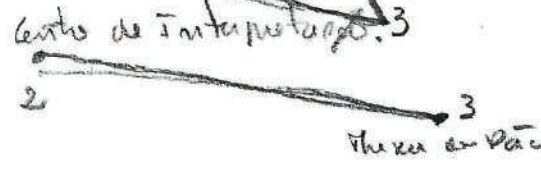

Assíntica mura Serra da Góte-la

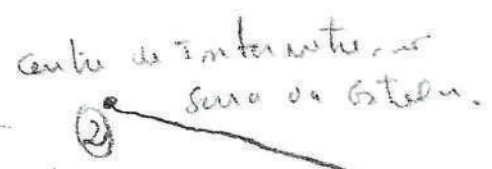

Torre
10-11-67

