

PLANTA DE PROPOSTA PARA ÁREA TÉCNICA E INSTALAÇÕES DA PISCINA

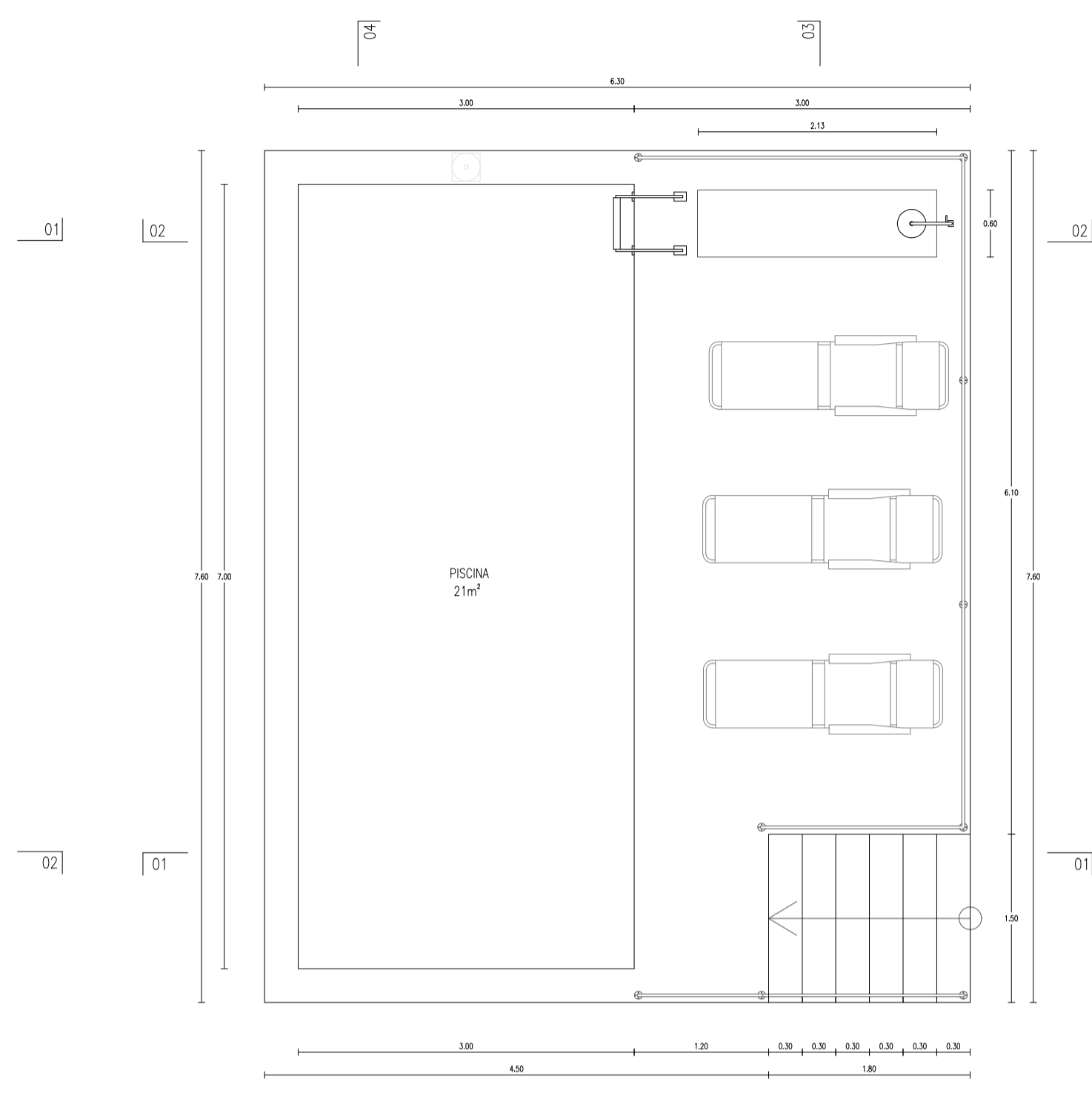

PLANTA PISCINA

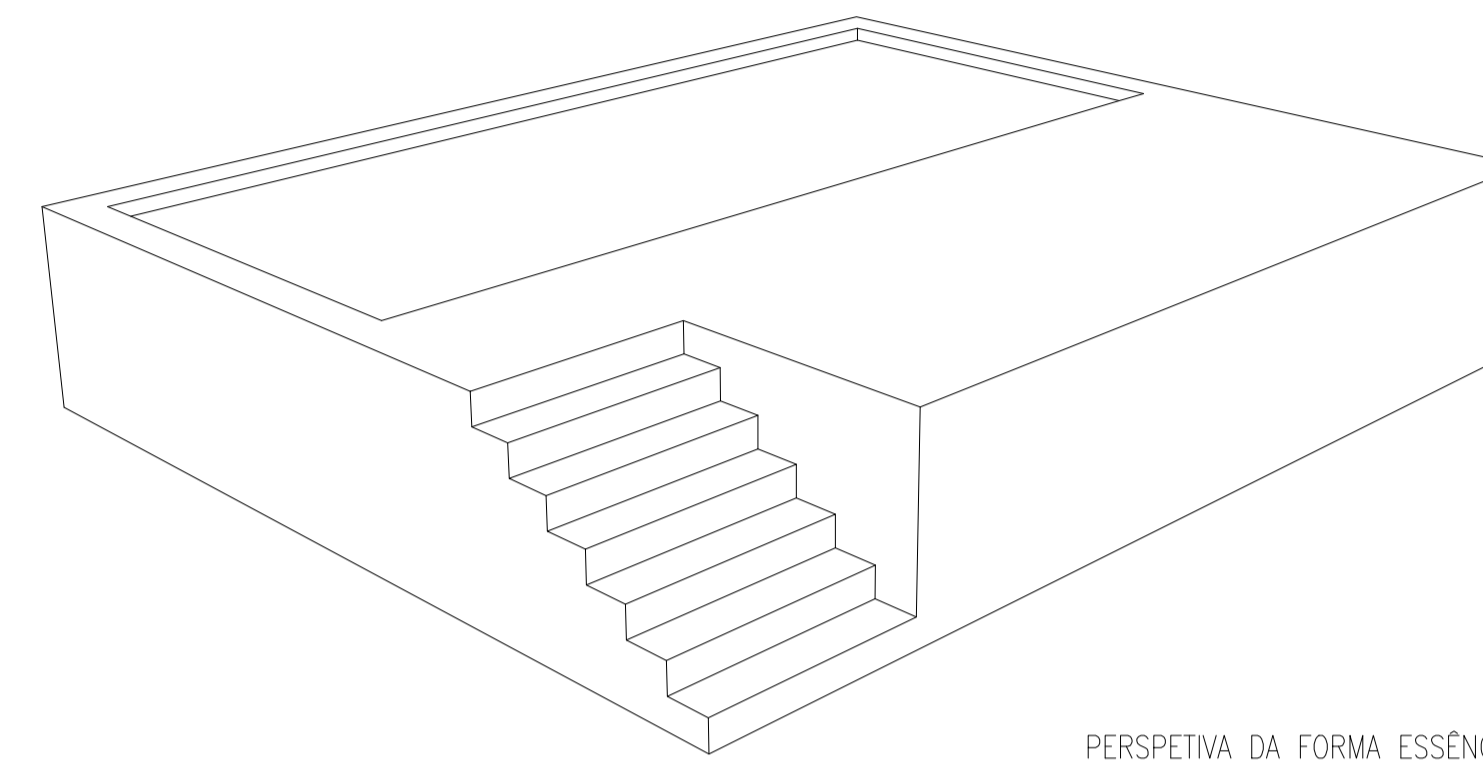

PERSPETIVA DA FORMA ESSENCIAL

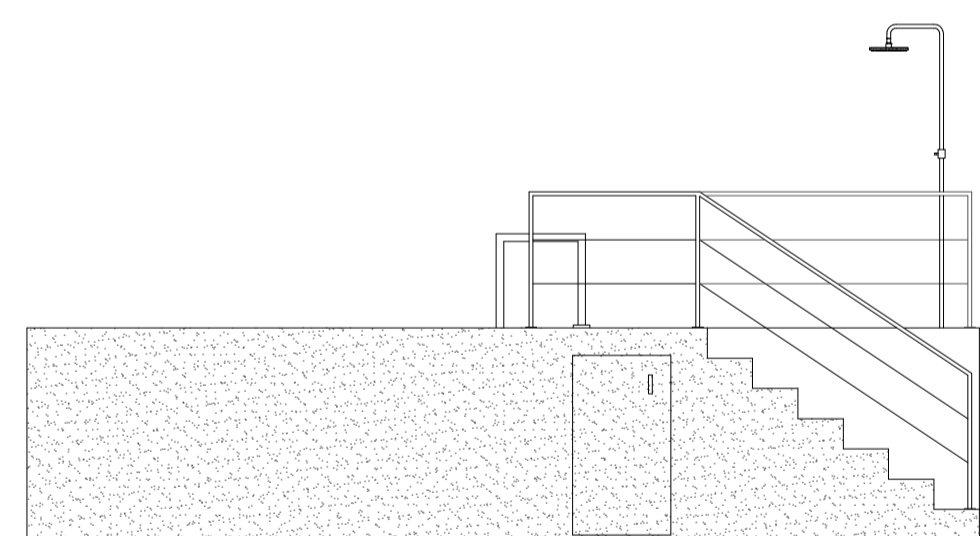

ALÇADO SUDESTE

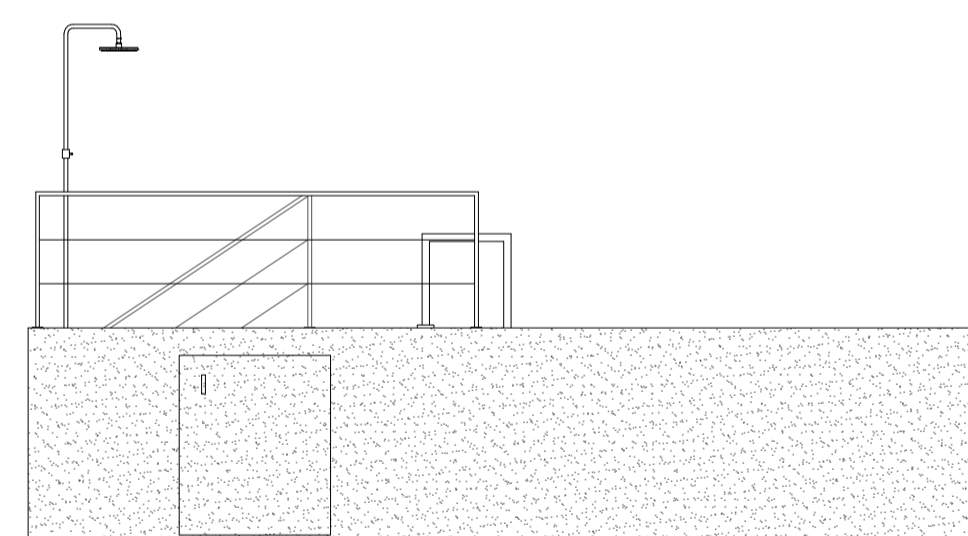

ALÇADO NOROESTE

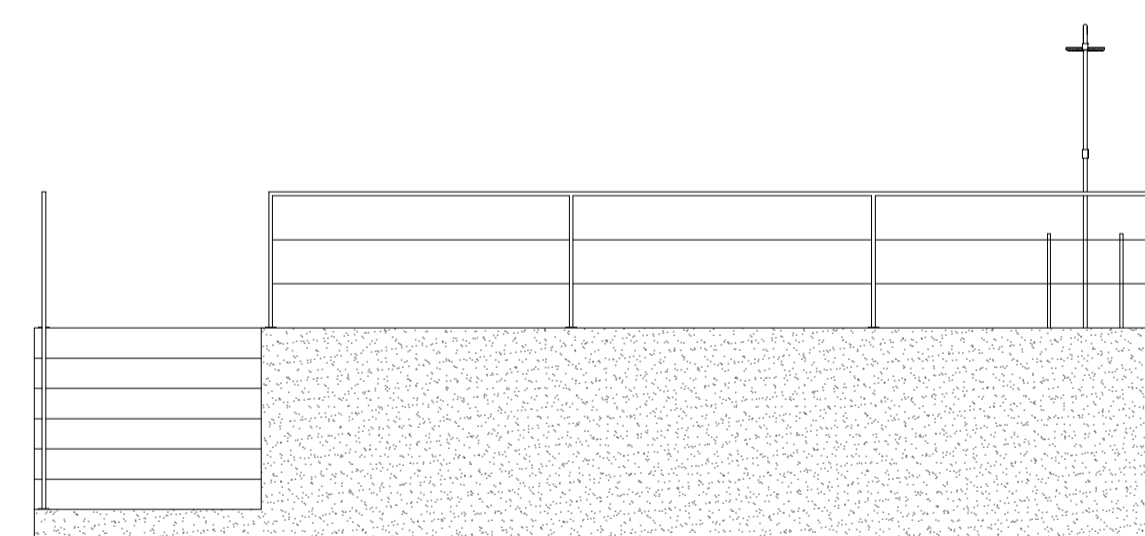

ALÇADO NORDESTE

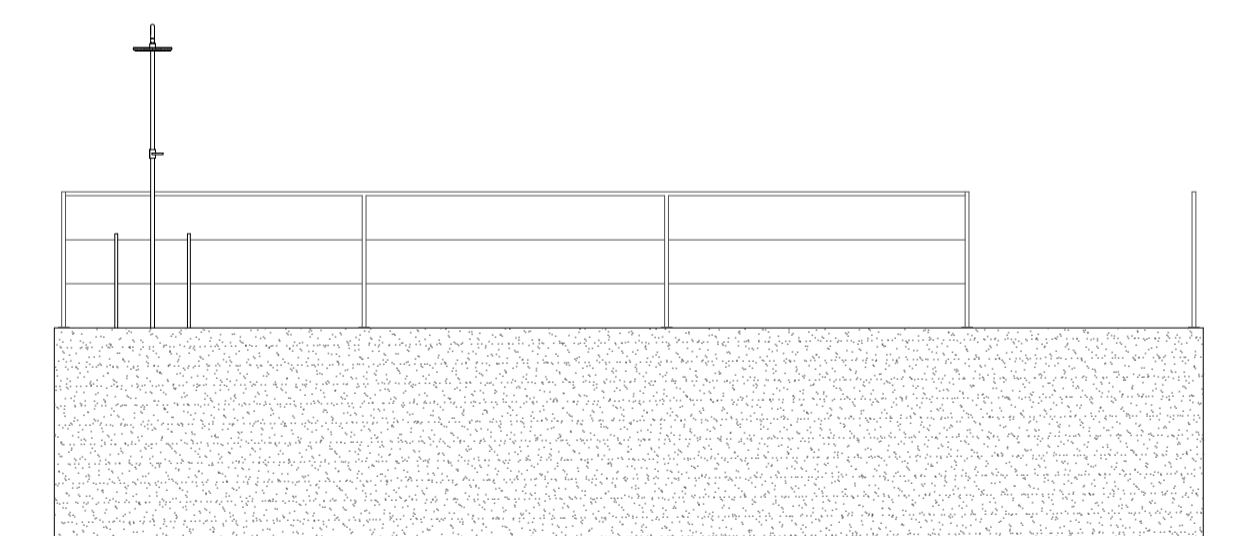

ALÇADO SUOESTE

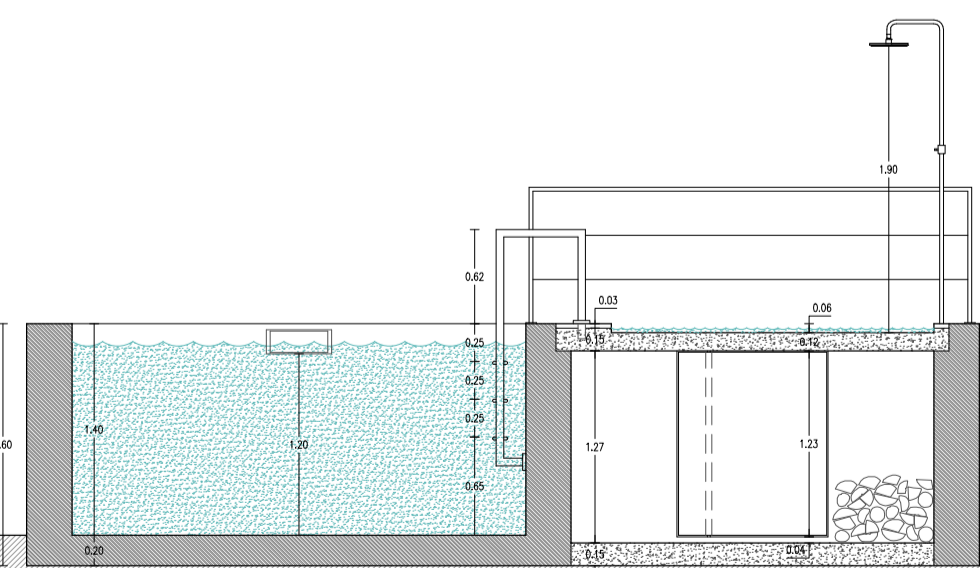

CORTE 1

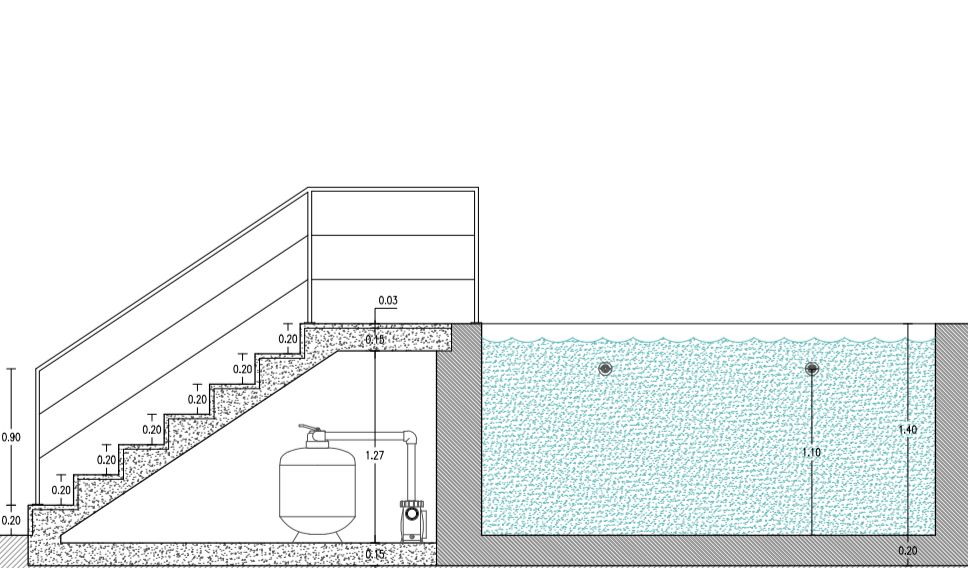

CORTE 2

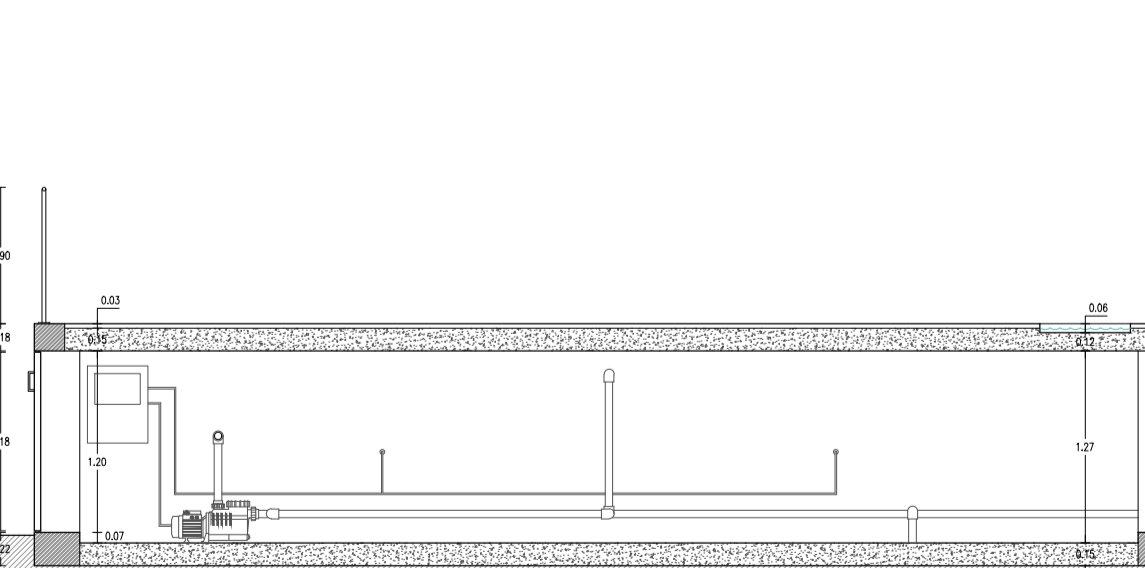

CORTE 3

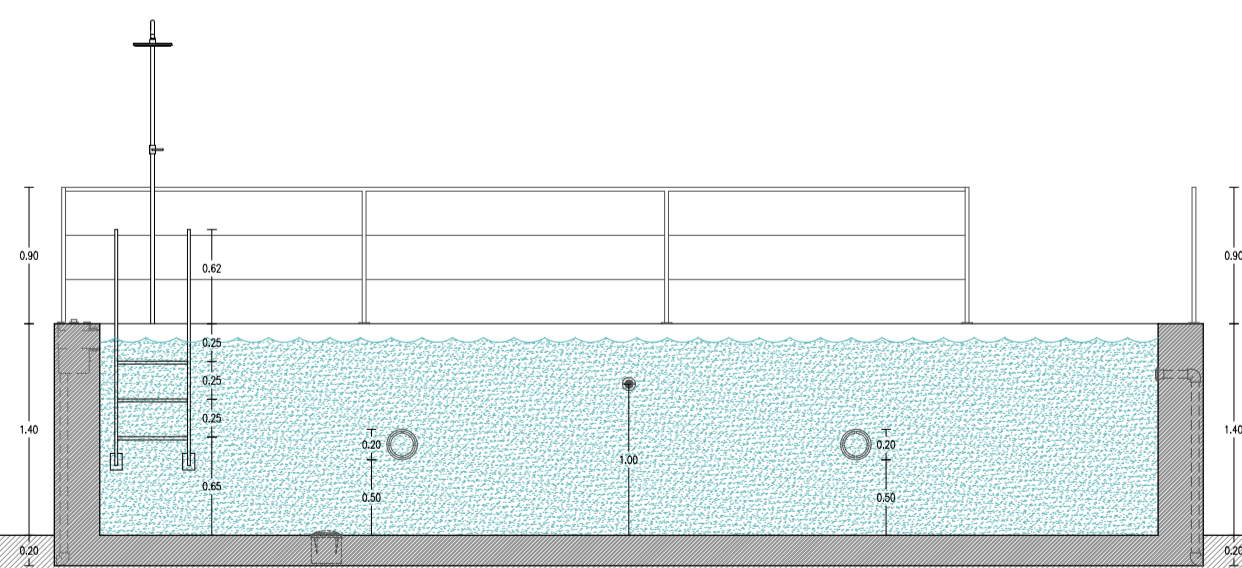

CORTE 4

PROJETO:
UMA CASA COM PASSADO, UM PASSADO COM FUTURO
REABILITAÇÃO DE CASA VERNÁCULAR

OBJETO:
PROJETO DE EXECUÇÃO
PISCINA

DATA:
OUTUBRO 2018

LOCAL:
LUGAR DE PEREIRA, (BASTO) SÃO CLEMENTE
CELORICO DE BASTO

ESCALAS:
ESCALA 1/50

DESENHO N°
19 - PE